

90° RR Bend

1/2

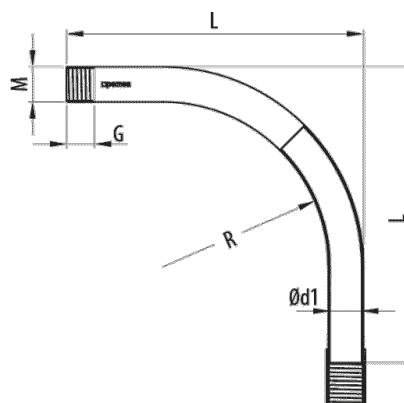

Description

90° threaded bend in EZ Protection System steel for the connection of RR conduits in installations that require high mechanical performance and medium resistance to corrosion. With an IP54 protection index. N mark of Aenor according to IEC 61386 standard. Available in different diameters.

Advantages

Threaded connection for joining RR conduits or accessories. Supplied complete with coupler.

Protection index EN 60529: IP54.

Working temperature: -45°C to + 400°C.

CE conformance with the directive 2014/35 and the IEC 61386 standard. N mark of Aenor according to IEC 61386.

Manufactured in PG protection system (standard EN-ISO 2081), suitable for indoor installations. Grade 2 corrosion resistance, according to IEC 61386. Medium indoor and outdoor protection.

Applications

Suitable for the creation of 90° angles in installations of RR rigid metal threaded conduits in applications of building, tertiary sector and industrial with high requirements of hygiene. Premises of public attendance and premises with risk of fire or explosion.

Solutions



www.pemsa-rejiband.com



Any information included in this document is property of Pemsa®. It cannot be copied, total or partially, nor disclosed to third parties nor used without the explicit and written authorization by Pemsa®. These documents total or partially, can be subject to patent and/or be patent pending and therefore protected by intellectual and industrial property rights. Pemsa, Rejiband, Pemsaband, Inducanal, Rejitech, Megaband, Pemsaflex are registered trademarks property of "Pemsa Cable Management, S.A."

Main technical characteristics

Ⓢ EZ	Ⓢ EZ2, Electrogalvanised	DN NW16, NW20, NW25, NW32, NW40, NW50, NW63	📏 M16, M20, M25, M32, M40, M50, M63
🛡️ Steel with surface coating	🔧 4000 N	🔧 20 J	🛡️ IP54
🔥 LIBRE DE HALÓGENOS,NO PROPAGADOR DE LA LLAMA		ETIM EC001493	🌡️ -45 / 400 °C

Product data

DN	📏	🔧	🔧	🔧	🔧	Ref	kg/u	🔧
NW16	M16	15	13.6	97	173	55014016	0.170	10
NW20	M20	15	17.6	93	180	55014020	0.220	10
NW25	M25	20	22.6	117	198	55014025	0.301	10
NW32	M32	20	29.6	129	232	55014032	0.499	10
NW40	M40	20	37	145	287	55014040	0.751	5
NW50	M50	20	57	160	351	55014050	1.157	5
NW63	M63	20	60	296	541	55014063	2.548	3

Ⓢ Protection System

- CU - Copper electroplated
- PG - Pregalvanised
- EZ - Electrogalvanised
- BC - Electrogalvanised Bichromate
- BK8 - High Resistance Coating
- GC - Hot Dip Galvanising
- INOX - Stainless Steel
- PT - Polyester Paint
- AL - Aluminum
- LN - Brass or Nickel-plated brass

🛡️ Insulating materials

- PC+ABS - Halogen Free Polycarbonate + ABS
- PVC - Polyvinyl Chloride
- PP - Halogen Free Polypropylene
- PA6 - Halogen Free Polyamide 6
- PA12 - Halogen Free Polyamide 12
- PU - Polyurethane
- PE - Polyethylene
- NBR - NBR rubber
- PET - Thermoplastic Polyester
- TPV - Thermoplastic