

Internal Joint

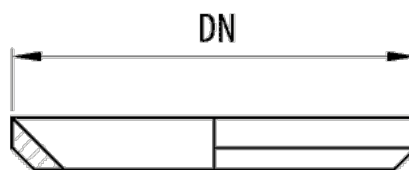

Description

Internal thermoplastic washer in white available in various sizes for internal installation in polyamide fittings of the Pemsaflex® range. It improves the seal and achieves IP67.

Advantages

Improves the tightness of the fitting on the conduit, reaching IP67.

Available in white.

Working temperature: -25°C to + 105°C.

CE conformity to the 2014/35 directive and the IEC 61386 standard.

Made of thermoplastic.

Applications

Suitable for installation inside polyamide fittings of the Pemsaflex® range, to improve the seal.

Solutions



Main technical characteristics

Colour	White RAL 9010	DN	NW 7, NW10, NW12, NW17, NW23, NW29, NW36, NW48	kg/μ	0.001		Thermoplastic Polyester		IP67
			ETIM EC000098						
	-25 / 105 °C		Flame retardant						

Product data

DN	Ref	
NW 7	39091000	50
NW10	39091100	50
NW12	39091200	50
NW17	39091400	50
NW23	39091500	30
NW29	39091600	30
NW36	39091700	10
NW48	39091800	10

Protection System

- CU - Copper electroplated
- PG - Pregalvanised
- EZ - Electrogalvanised
- BC - Electrogalvanised Bichromate
- BK8 - High Resistance Coating
- GC - Hot Dip Galvanising
- INOX - Stainless Steel
- PT - Polyester Paint
- AL - Aluminum
- LN - Brass or Nickel-plated brass

Insulating materials

- PC+ABS - Halogen Free Polycarbonate + ABS
- PVC - Polyvinyl Chloride
- PP - Halogen Free Polypropylene
- PA6 - Halogen Free Polyamide 6
- PA12 - Halogen Free Polyamide 12
- PU - Polyurethane
- PE - Polyethylene
- NBR - NBR rubber
- PET - Thermoplastic Polyester
- TPV - Thermoplastic

