

Omega SPLUS Bracket

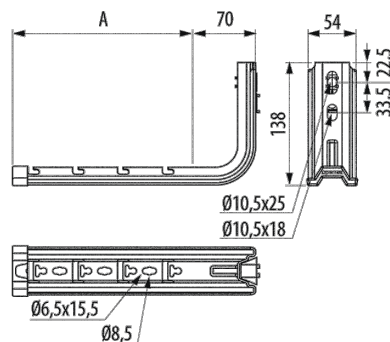
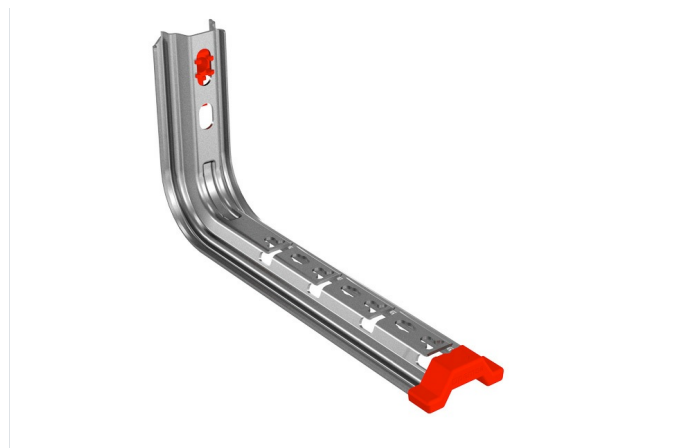

Description

Support with omega profile and universal connection system for Rejiband® and Pemsaband® trays mounted on the wall, channel or from the ceiling. Click fixing system. Made of steel and available for widths of 100, 150, 200, 300 and 400 mm and in various Protection Systems.

Advantages

Click system allows fast connection of the wire mesh tray without the need of fixings. Greater economy and quick assembly.

Universal mounting system compatible with Rejiband® grid trays, Pemsaband® sheet and PVC trays. A single support for all trays. Reduction in the number of references.

Reinforced omega profile. Increase support features. Includes plugs and protectors to facilitate installation and safeguard the installer.

N Mark of Aenor, in accordance with IEC 61537 and CE conformity to Directive 2014/35 / EU. Fire resistance E90 according to DIN 4102-12.

Available in several protection systems: PG, GC, BK8 and stainless steel AISI 304 and AISI 316L.

Applications

Suitable for supporting medium loads of cable trays for electrical installations and/or of telecommunications in: Civil works, tunnels, car parks, public buildings, commercial centres, large infrastructures such as: Airports, underground, rail, tertiary sector, industrial naval, petrochemical, textile, chemical and food applications, according to the finish.

Solutions



INDUSTRIA ALIMENTARIA FOTOVOLTAICA CENTROS DE DATOS EDIFICACIÓN. TERCIARIO RESISTENCIA AL FUEGO



www.pemsa-rejiband.com

Any information included in this document is property of Pemsa®. It cannot be copied, total or partially, nor disclosed to third parties nor used without the explicit and written authorization by Pemsa®. These documents total or partially, can be subject to patent and/or be patent pending and therefore protected by intellectual and industrial property rights. Pemsa, Rejiband, Pemsaband, Inducanal, Rejitech, Megaband, Pemsaflex are registered trademarks property of "Pemsa Cable Management, S.A."

Main technical characteristics

 100, 150, 200, 300, 400

 5

ETIM
EC001003

Product data

Ⓢ	Class EC 61537	Ⓚ	Ref	kg/u	Ⓜ	CTA Reg	°C	⚡
PG	Class 3	100	62021104	0.231	Steel with surface coating	60	-50 / 150 °C	E90 (90 min. 1000°C)
PG	Class 3	150	62021154	0.258	Steel with surface coating	60	-50 / 150 °C	E90 (90 min. 1000°C)
PG	Class 3	200	62021204	0.406	Steel with surface coating	60	-50 / 150 °C	E90 (90 min. 1000°C)
PG	Class 3	300	62021304	0.509	Steel with surface coating	38	-50 / 150 °C	E90 (90 min. 1000°C)
PG	Class 3	400	62021404	0.611	Steel with surface coating	28	-50 / 150 °C	E90 (90 min. 1000°C)
AZ+	Class 8	100	62031104	0.258	Steel with surface coating	60	-50 / 150 °C	A1 No combustible
AZ+	Class 8	150	62031154	0.287	Steel with surface coating	60	-50 / 150 °C	A1 No combustible
AZ+	Class 8	200	62031204	0.449	Steel with surface coating	60	-50 / 150 °C	A1 No combustible
AZ+	Class 8	300	62031304	0.562	Steel with surface coating	38	-50 / 150 °C	A1 No combustible
AZ+	Class 8	400	62031404	0.675	Steel with surface coating	28	-50 / 150 °C	A1 No combustible
INOX	Class 9C	100	62051104	0.248	Stainless steel AISI 304	60	-50 / 150 °C	E90 (90 min. 1000°C)
INOX	Class 9C	150	62051154	0.277	Stainless steel AISI 304	60	-50 / 150 °C	E90 (90 min. 1000°C)
INOX	Class 9C	200	62051204	0.439	Stainless steel AISI 304	60	-50 / 150 °C	E90 (90 min. 1000°C)
INOX	Class 9C	300	62051304	0.552	Stainless steel AISI 304	38	-50 / 150 °C	E90 (90 min. 1000°C)
INOX	Class 9C	400	62051404	0.665	Stainless steel AISI 304	28	-50 / 150 °C	E90 (90 min. 1000°C)
INOX	Class 9D	100	62061104	0.248	Acero inoxidable AISI 316L	60	-50 / 150 °C	E90 (90 min. 1000°C)
INOX	Class 9D	150	62061154	0.277	Acero inoxidable AISI 316L	60	-50 / 150 °C	E90 (90 min. 1000°C)
INOX	Class 9D	200	62061204	0.439	Acero inoxidable AISI 316L	60	-50 / 150 °C	E90 (90 min. 1000°C)
INOX	Class 9D	300	62061304	0.552	Acero inoxidable AISI 316L	38	-50 / 150 °C	E90 (90 min. 1000°C)
INOX	Class 9D	400	62061404	0.665	Acero inoxidable AISI 316L	28	-50 / 150 °C	E90 (90 min. 1000°C)
BK8	Class 8	100	62081104	0.264	Steel with surface coating	60	-50 °C	E90 (90 min. 1000°C)
BK8	Class 8	150	62081154	0.293	Steel with surface coating	60	-50 °C	E90 (90 min. 1000°C)
BK8	Class 8	200	62081204	0.457	Steel with surface coating	60	-50 °C	E90 (90 min. 1000°C)
BK8	Class 8	300	62081304	0.572	Steel with surface coating	38	-50 / 150 °C	E90 (90 min. 1000°C)
BK8	Class 8	400	62081404	0.687	Steel with surface coating	28	-50 / 150 °C	E90 (90 min. 1000°C)
CU	Class 1	100	82003270	0.248	Steel with surface coating	60	-50 / 150 °C	A1 No combustible
CU	Class 1	150	82003271	0.277	Steel with surface coating	60	-50 / 150 °C	A1 No combustible
CU	Class 1	200	82003272	0.440	Steel with surface coating	60	-50 / 150 °C	A1 No combustible
CU	Class 1	300	82003273	0.552	Steel with surface coating	38	-50 / 150 °C	A1 No combustible
CU	Class 1	400	82003274	0.670	Steel with surface coating	28	-50 / 150 °C	A1 No combustible

Ⓢ Protection System

- CU - Copper electroplated
- PG - Pregalvanised
- EZ - Electrogalvanised
- BC - Electrogalvanised Bichromate
- BK8 - High Resistance Coating

Omega SPLUS Bracket

GC - Hot Dip Galvanising

INOX - Stainless Steel

PT - Polyester Paint

AL - Aluminum

LN - Brass or Nickel-plated brass

Insulating materials

PC+ABS - Halogen Free Polycarbonate + ABS

PVC - Polyvinyl Chloride

PP - Halogen Free Polypropylene

PA6 - Halogen Free Polyamide 6

PA12 - Halogen Free Polyamide 12

PU - Polyurethane

PE - Polyethylene

NBR - NBR rubber

PET - Thermoplastic Polyester

TPV - Thermoplastic

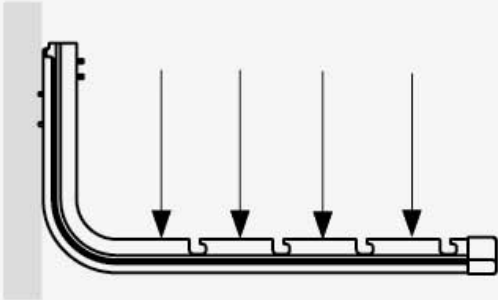

Load diagrams

↓CTA↓ (kg)		kg
	100	60
	150	60
	200	60
	300	38
	400	28

Product applications



Omega SPLUS Bracket

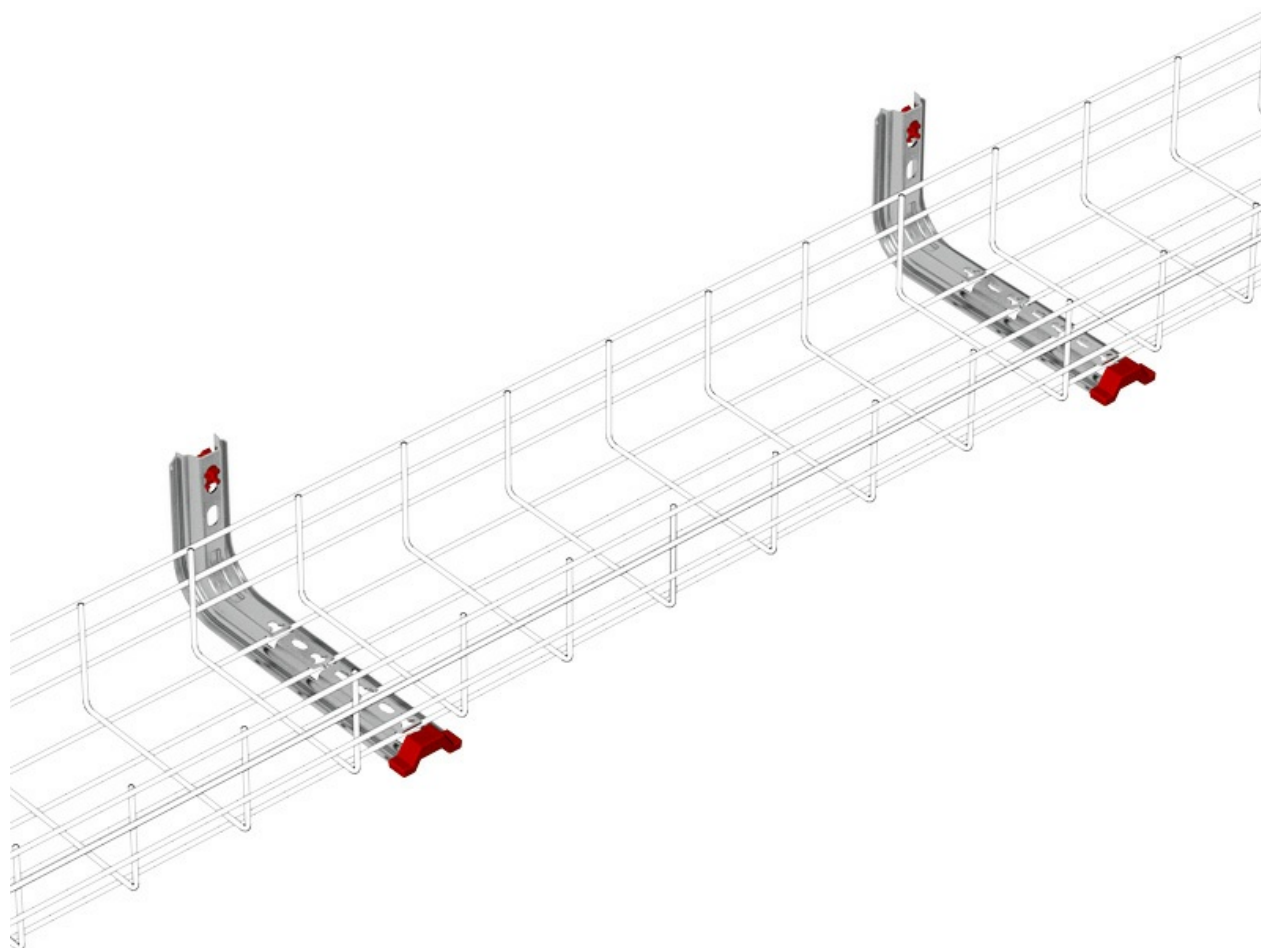

Omega SPLUS Bracket

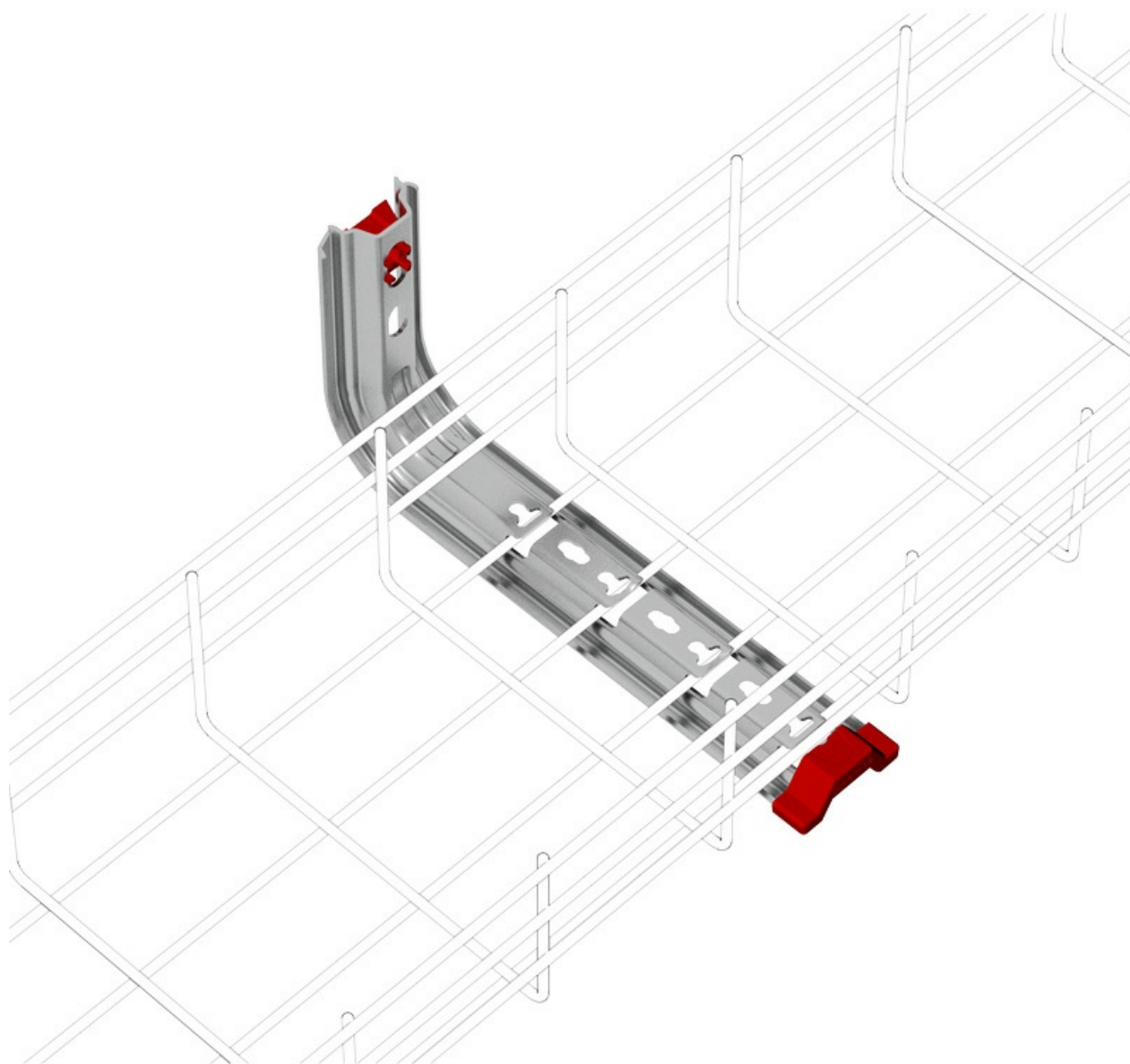

Omega SPLUS Bracket

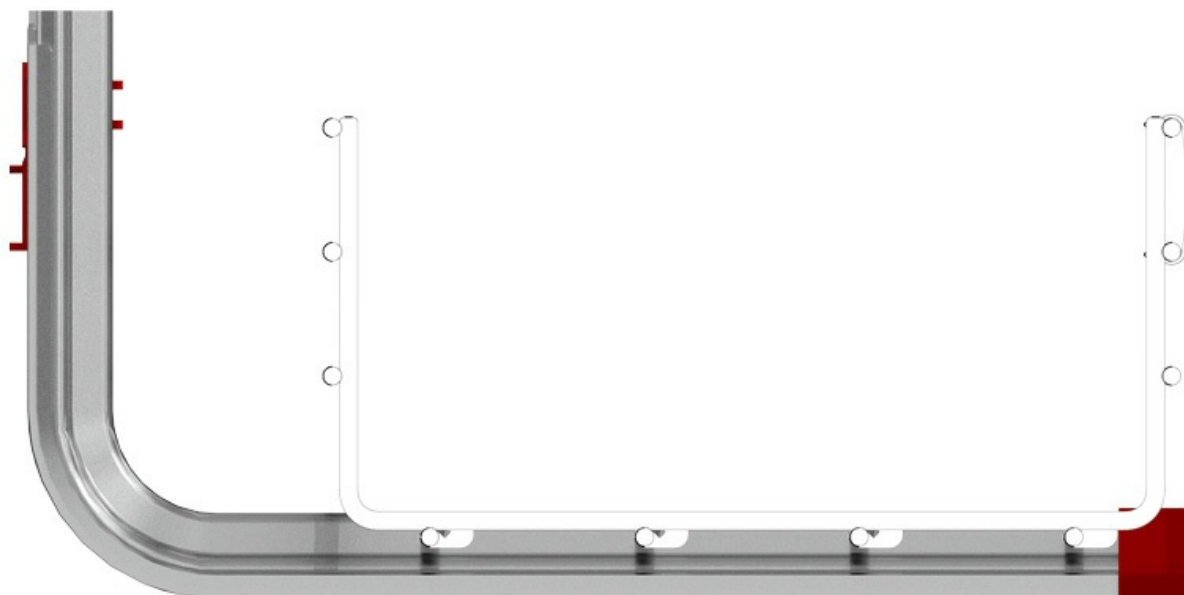

Omega SPLUS Bracket

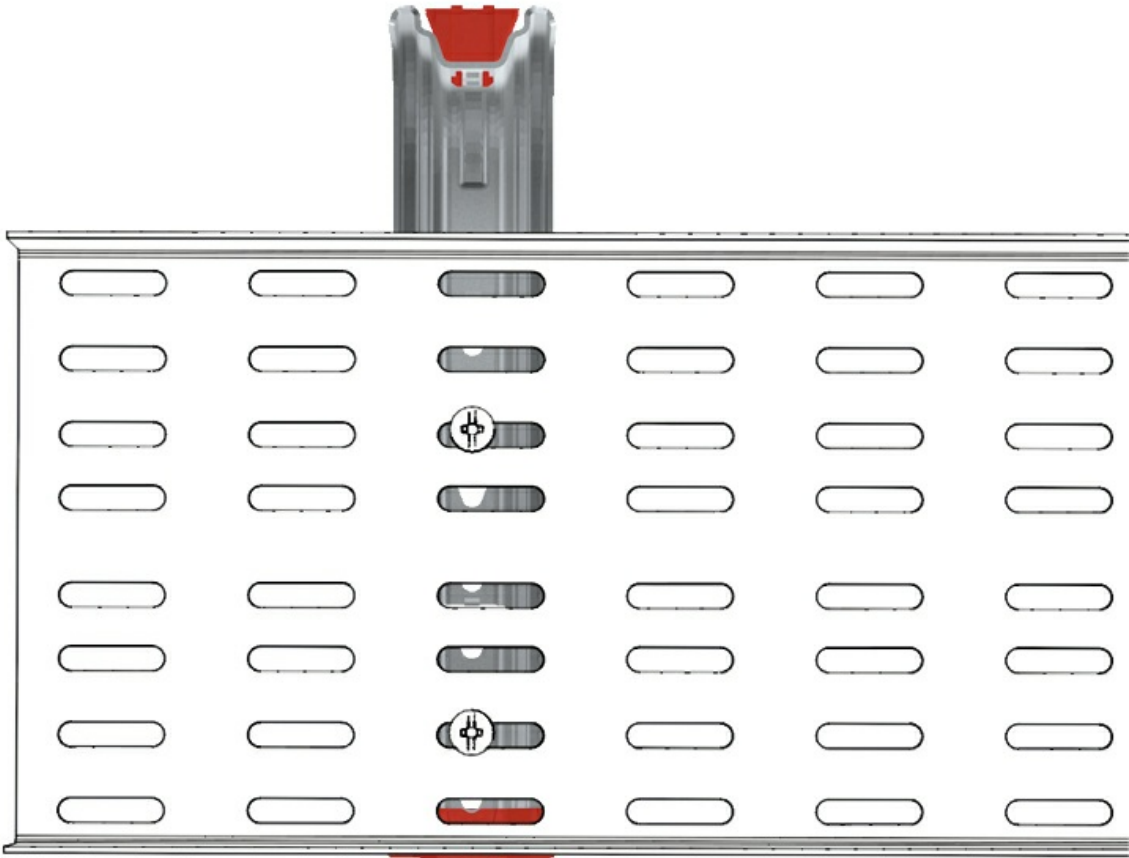

Omega SPLUS Bracket

